

1 2 3 4 5 6 7 8 9 10 11

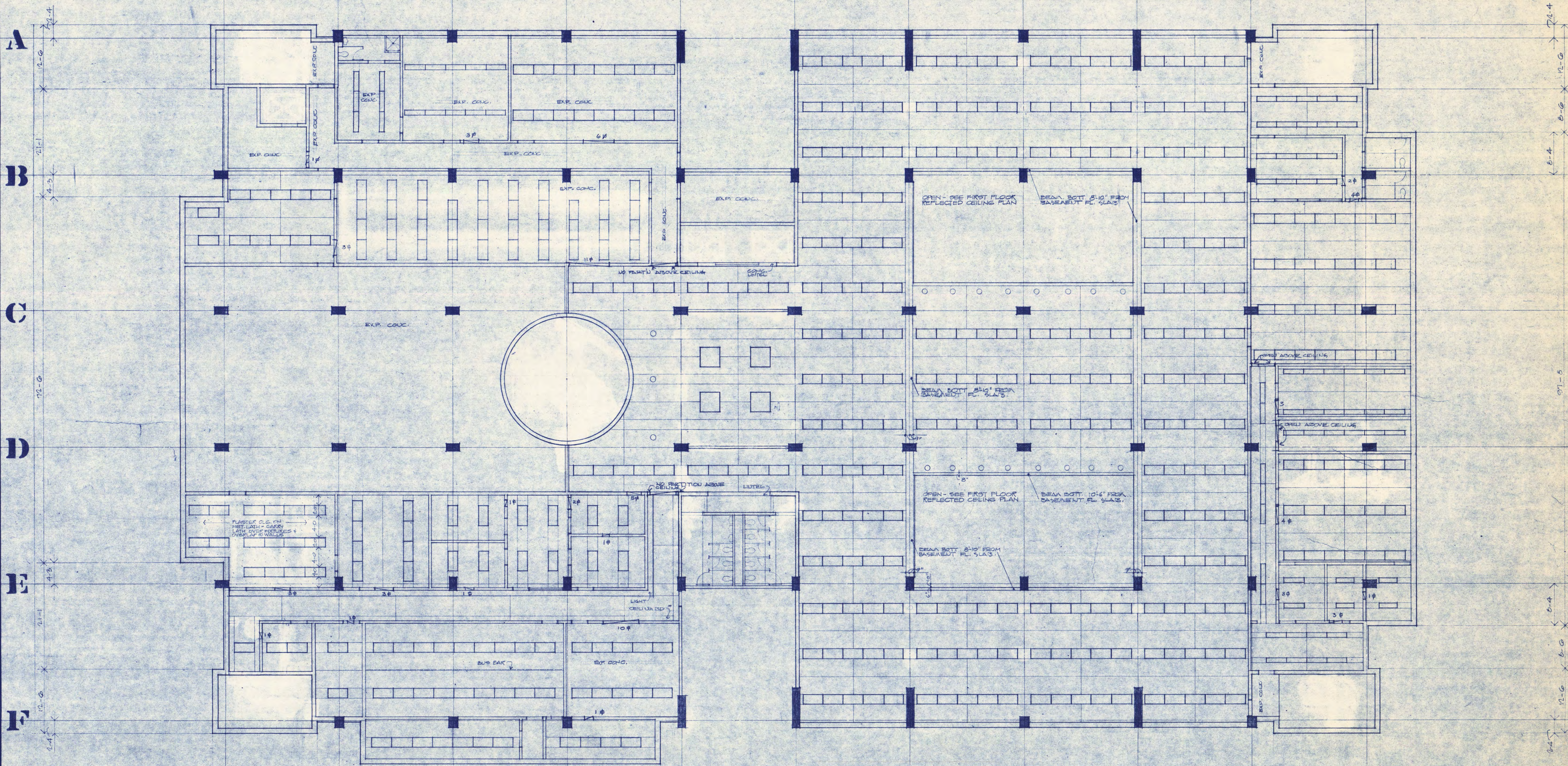

NOTE:
 8" INDICATES RETURN AIR OPENING 10' 6" FEET TO BE LEFT IN THE EXACTLY SQUARE THE SLAB 2' ABOVE THE CEILING.

CENTENNIAL HALL
 LEARNING RESOURCES CENTER

ST. CLOUD STATE COLLEGE
 ST. CLOUD, MINNESOTA

STATE PROJECT 3947
 D.E. NO. 4-6-00141-0
 MASTER BUILDING 44

BASEMENT REFLECTED CEILING PLAN
 SCALE 1/8" = 1'-0"



COMM. 6526
 DRAWN: L.G.
 DATE: 7-18-66
 CHECKED: R.L.

S.C. SMILEY & ASSOCIATES - ARCHITECTS
 Minneapolis, Minn.

SHEET
25
 of 29

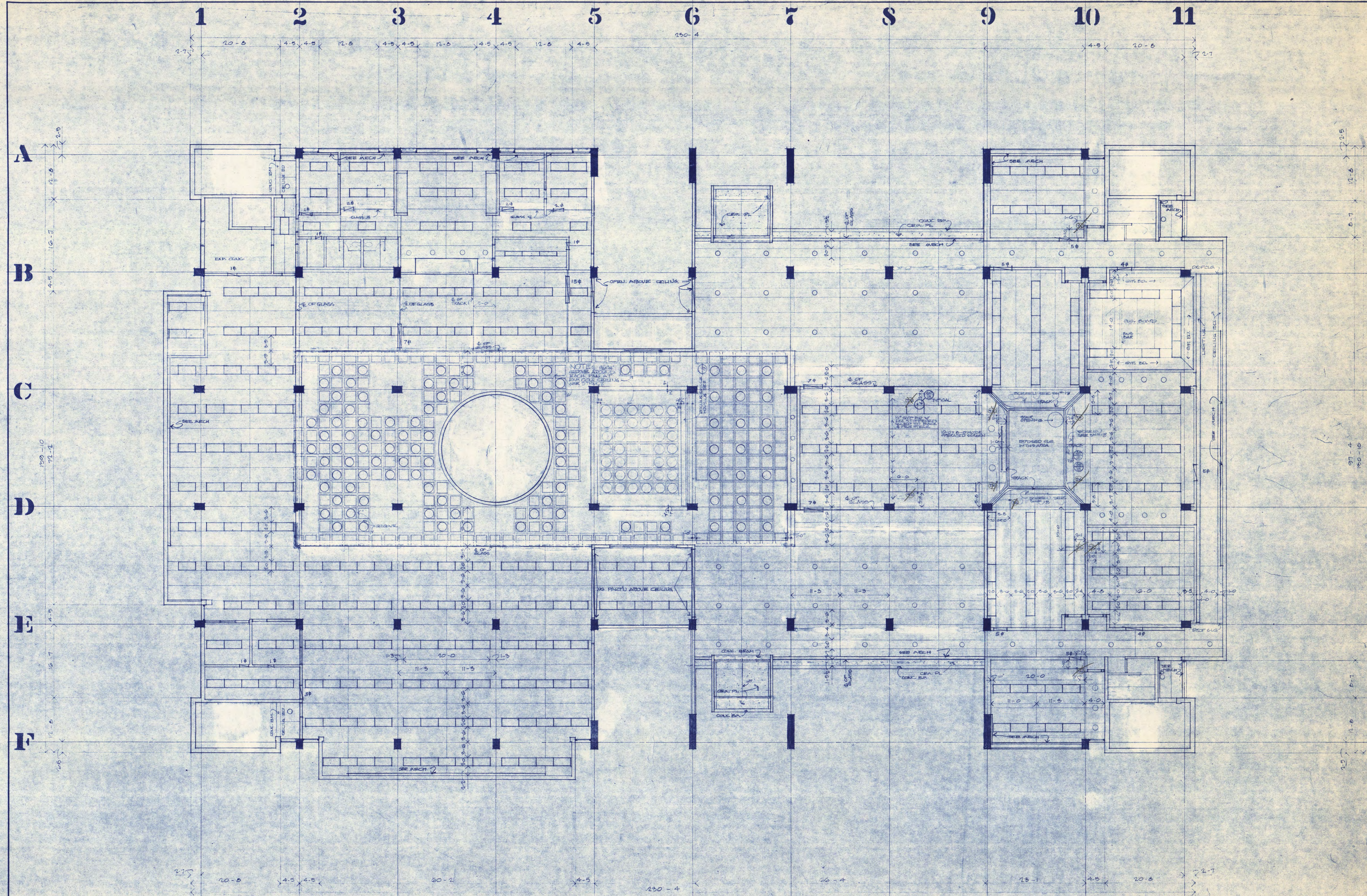

CENTENNIAL HALL
LEARNING RESOURCES CENTER

ST. CLOUD STATE COLLEGE
ST. CLOUD, MINNESOTA

STATE PROJECT 3947
O.E. NO. 4-G-00141-0
MASTER BUILDING 44

FIRST FLOOR REFLECTED CEILING PLAN
SCALE 1/8" = 1'-0"



COMM.
DRAWN
DATE
CHECKED

S.C. SMILEY & ASSOCIATES - ARCHITECTS
Minneapolis Minn.

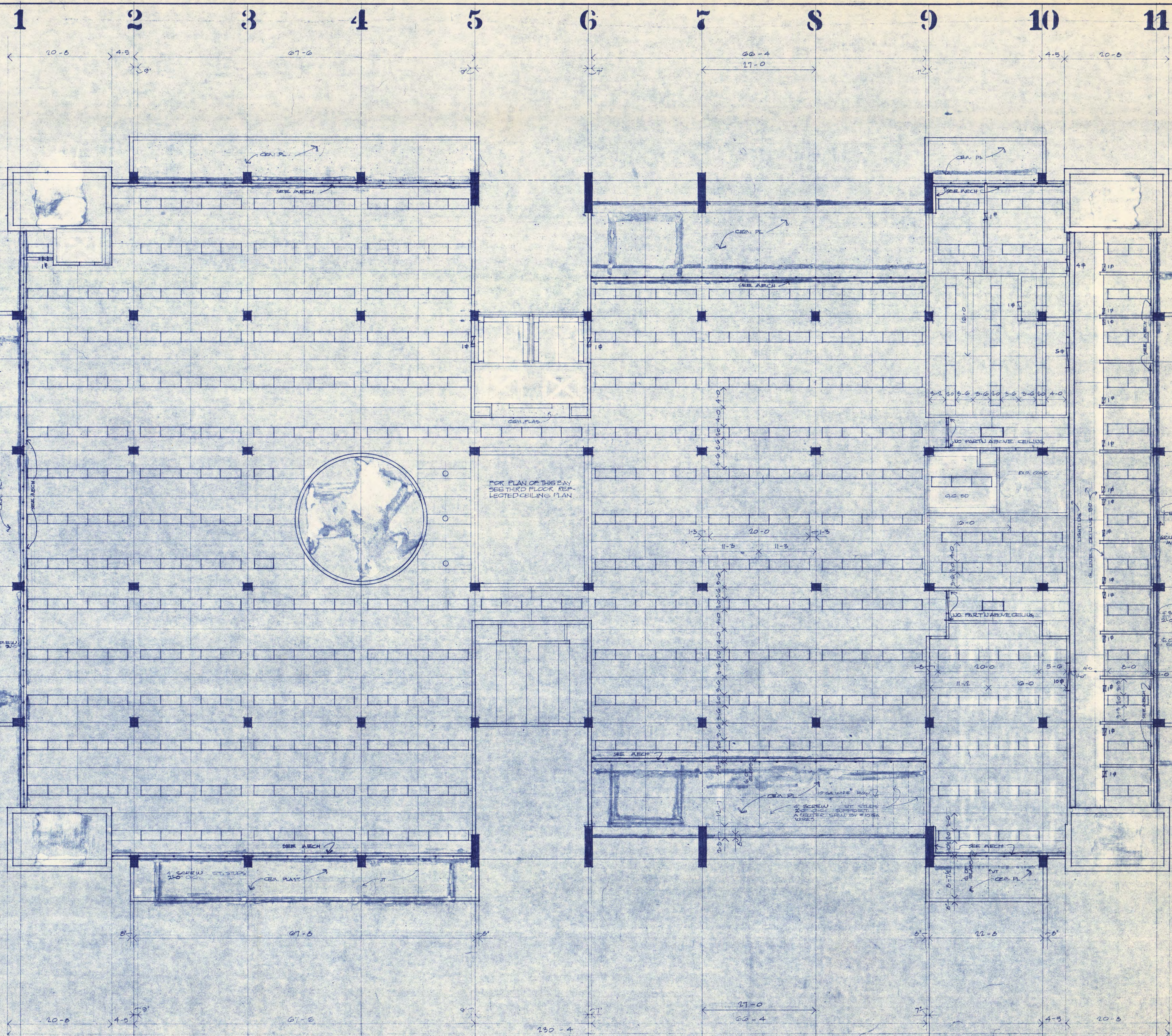

CENTENNIAL HALL
LEARNING RESOURCES CENTER

ST. CLOUD STATE COLLEGE
ST. CLOUD, MINNESOTA

STATE PROJECT 3947
O. E. NO. 4-6-00/41-0
MASTER BUILDING 44

SECOND FLOOR REFLECTED CEILING PLAN
SCALE 1/8" = 1'-0"



COMM. 4-52-66
DRAWN: L.S.
DATE: 7-18-66
CHECKED: E.L.

S.C. SMILEY & ASSOCIATES - ARCHITECTS
Minneapolis Minn.

SHEET
27
OF 29

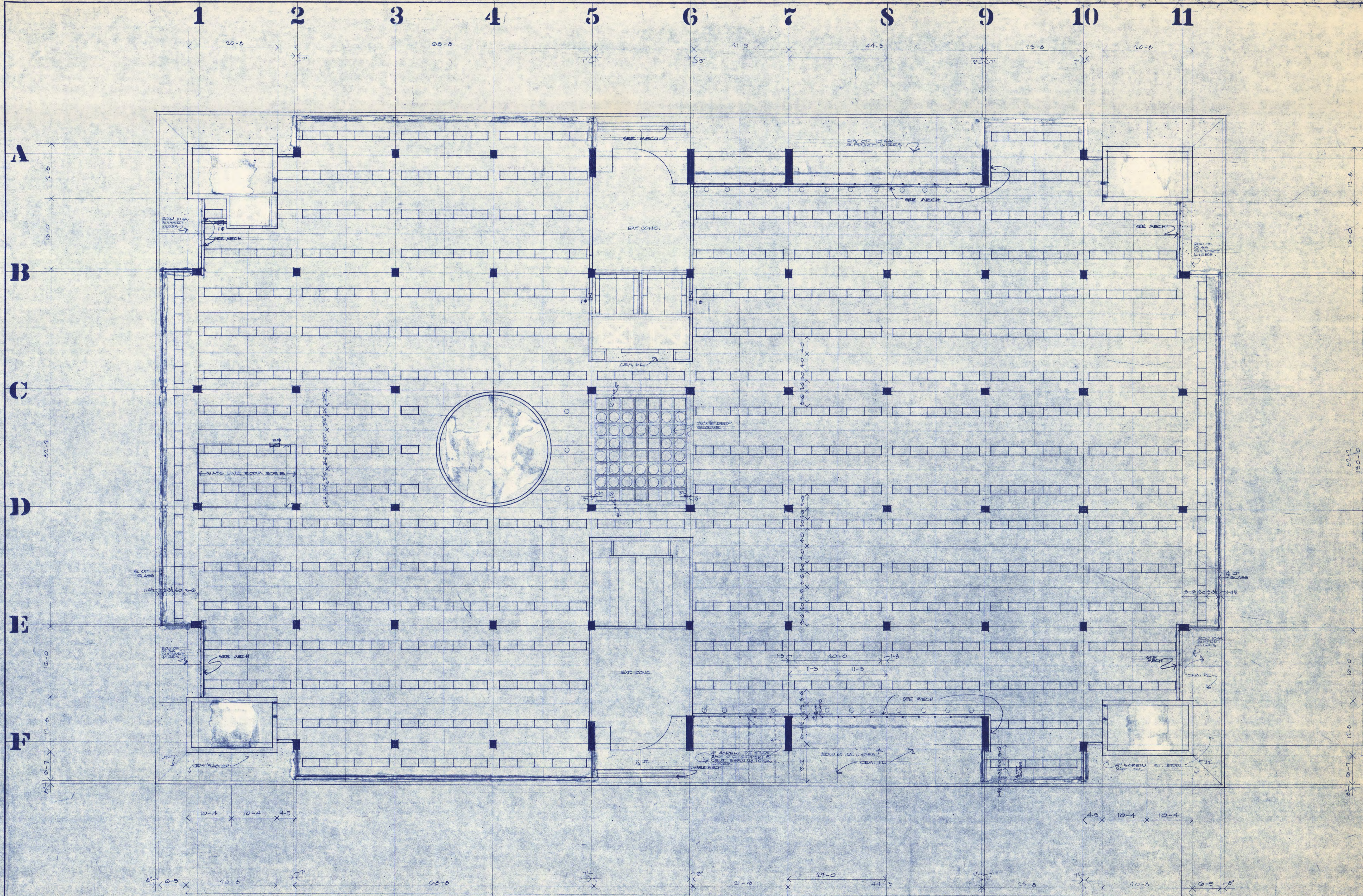

CENTENNIAL HALL
LEARNING RESOURCES CENTER

ST. CLOUD STATE COLLEGE
ST. CLOUD, MINNESOTA

STATE PROJECT NO. 3947
O.E. NO. 4-6-00141-0
MASTER BUILDING 44

THIRD FLOOR REFLECTED CEILING PLAN
SCALE 1/8" = 1'-0"



COMM: 25/26
DRAWN: LES
DATE: 7-13-66
CHECKED: R.W.

S.C. SMILEY & ASSOCIATES - ARCHITECTS
Minneapolis, Minn.