

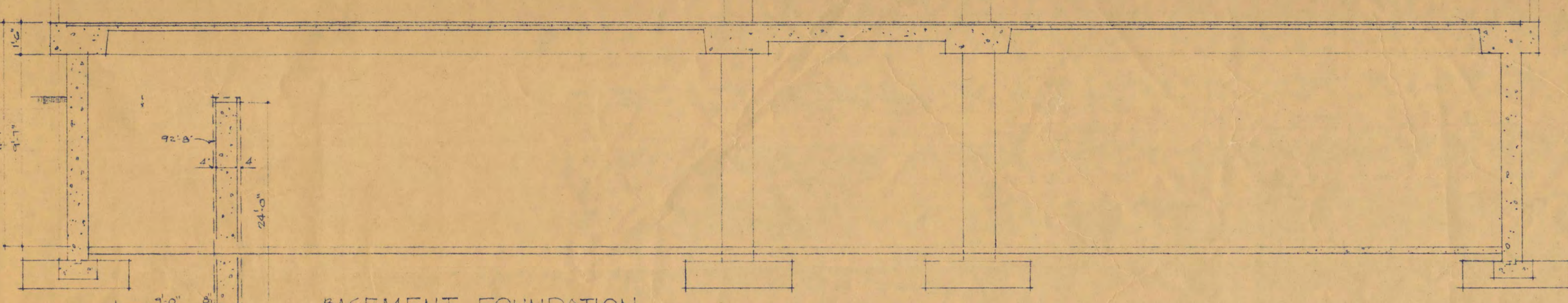



FOUNDATION SECTION A-A scale 1/4" = 1'-0"



BASEMENT FOUNDATION SECTION B-B scale 1/4" = 1'-0"

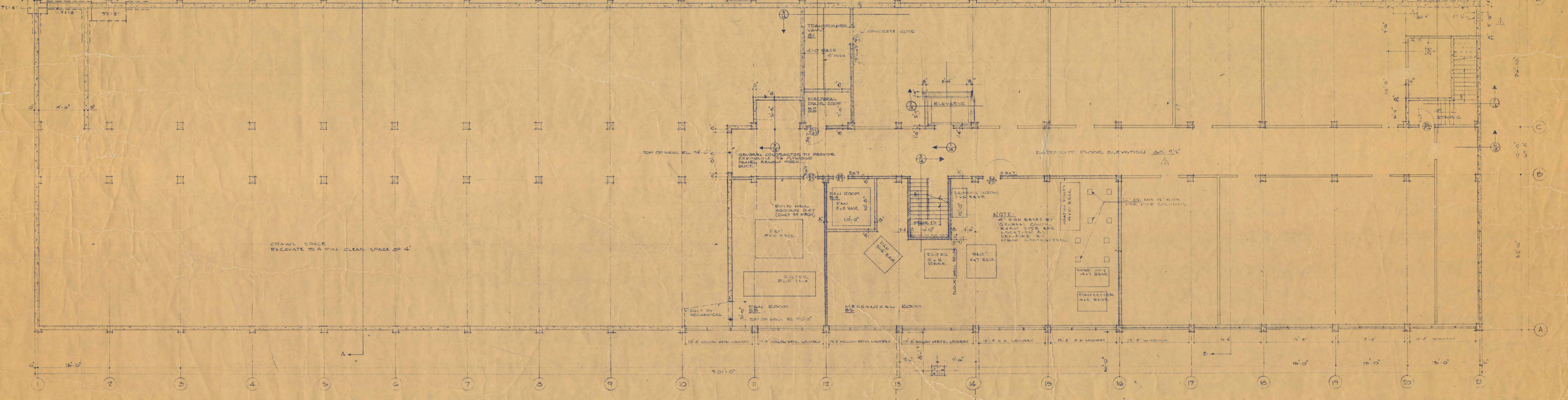
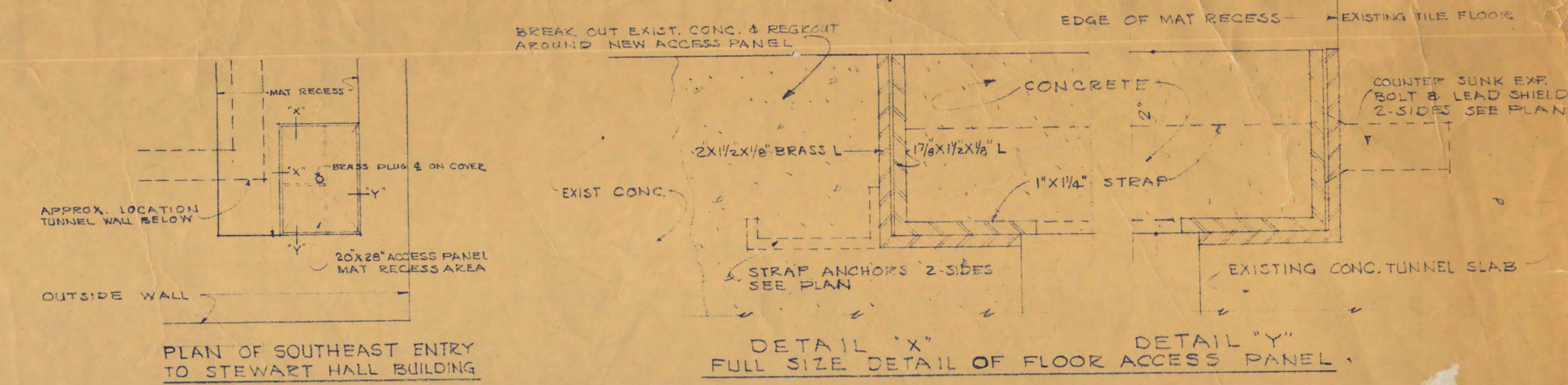
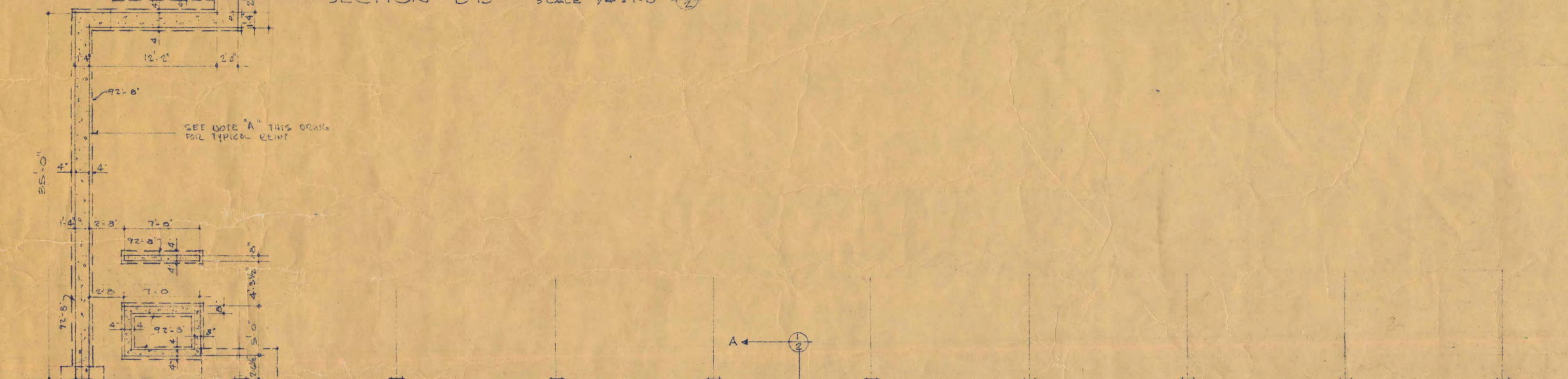

BASEMENT PLAN scale 1/8" = 1'-0"

**BASEMENT FINISH SCHEDULE**  
 CONCRETE FLOORS IN ALL AREAS EXCEPT CRAWL SPACE.  
 WALLS AND CEILING CONCRETE BLOCK / FINISH CONCRETE AS INDICATED.  
 STAIRS TO BE PAINTED AND GROUTED TILES.  
 PAINT METAL WINDOWS / POLISHED METAL LOUVERES.  
 PAINT ALL PIPES, PIPE COVERS, DUCTS, AND DUCT COVERINGS (EXCEPT IN CRAWL SPACE).

SCIENCE AND MATHEMATICS BUILDING		ST. CLOUD STATE COLLEGE	
ST. CLOUD, MINNESOTA		ST. PAUL, MINNESOTA	
DEPARTMENT OF ADMINISTRATION		STATE OF MINNESOTA	
ARCHITECTURAL AND ENGINEERING DIVISION		ST. PAUL, MINNESOTA	
A.J. NELSON, STATE ARCHITECT		JONAS B. SANDERSON, STRUCTURAL ENGINEER	
TRAYNOR AND HERMANSON, ARCHITECTS		ST. CLOUD, MINN.	
BAUMANN AND MOORE, INC. CONSULTING ENGINEERS		ST. PAUL, MINN.	
DATE		SHEET NO.	
REVISED	APPROVED BY	PRESIDENT ST. CLOUD STATE COLLEGE	A-2
DATE	APPROVED BY	STATE COLLEGE BOARD	OF
DRAWN BY	APPROVED BY	COMMISSIONER OF ADMINISTRATION	STATE PROJECT NUMBER
CHECKED BY	APPROVED BY	AN AUTHORIZED SIGNATURE	



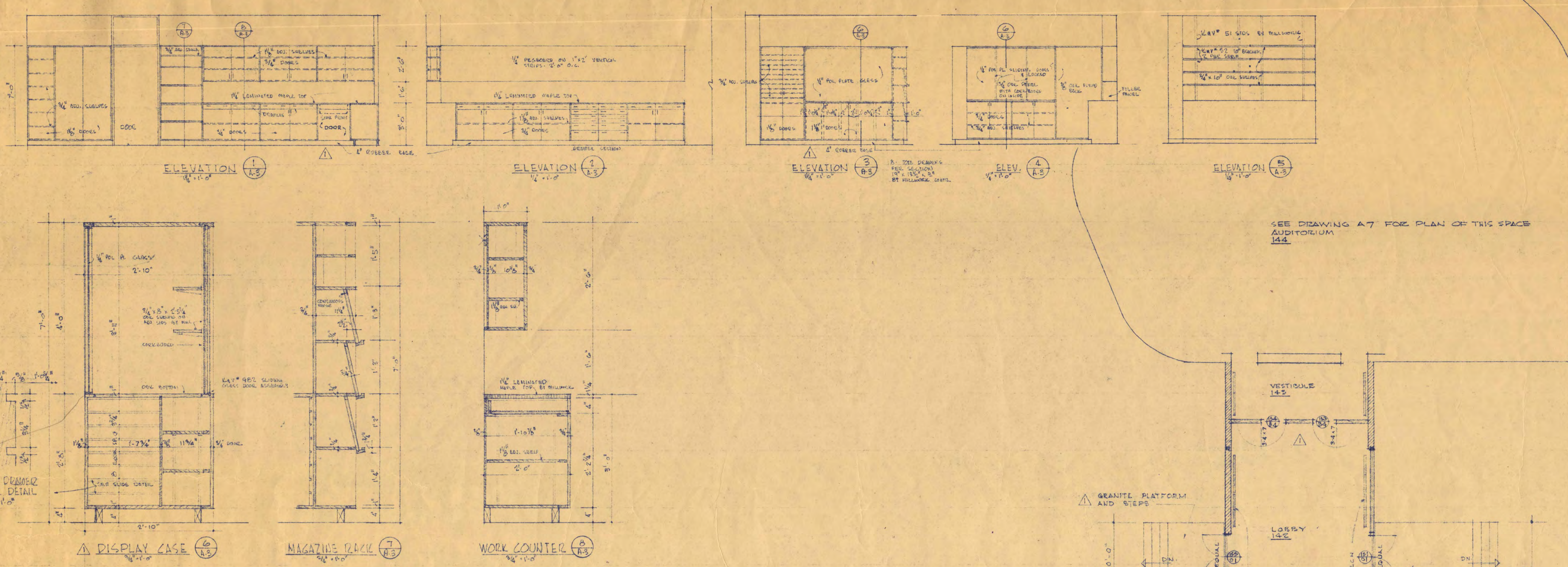

NO.	SPACE	FLOORS		BASE		WALLS		CEILING		PAINT		REMARKS
		TILE	CONCRETE	OTHER	PLASTER	GLAZED TILE	OTHER	GLAZED TILE	OTHER	PLASTER	PAINT	
101	MACHINE											
102	LECTURE											
103	LECTURE											
104	AVIATION											
105	STORAGE											
106	OFFICE											
107	OFFICE											
108	OFFICE											
109	OFFICE											
110	OFFICE											
111	OFFICE											
112	OFFICE											
113	OFFICE											
114	OFFICE											
115	STAIR ROOM											
116	CORRIDOR											
117	CORRIDOR											
118	JANITOR											
119	CLOSET											
120	WOMEN'S TOILET											
121	COATS											
122	MEN'S TOILET											
123	GENERAL OFFICE											
124	MEN'S TOILET											VARNISH WOOD WALL
125	CORRIDOR											
126	LECTURE											
127	LECTURE											
128	LABORATORY											
129	STORAGE											
130	LECTURE LABORATORY											
131	RECEIVING OFFICE											
132	GENERAL BOTANY											
133	STORAGE											
134	ADVANCED BOTANY											
135	HERBARIUM											
136	STORAGE											
137	LECTURE											
138	HEADHOUSE											
139	GREENHOUSE											
140	GREENHOUSE											
141	STAIR											
142	STAIR A											
143	STAIR B											
144	STAIR C											
145	STAIR D											
146	LOBBY VESTIBULE											
147	ADDITORIUM											

SYMBOLS DESIGNATE THE FINISHES FOR THE FOLLOWING:  
 A ASPHALT TILE  
 B GLAZED CERAMIC TILES  
 C GLAZED TERRAZZO  
 D GLAZED ENAMEL  
 E PLASTER  
 F SAND FLOT PLASTER  
 G QUARRY TILE  
 H LIGHTWEIGHT CONG. BLOCK  
 I BRICK  
 J CONCRETE

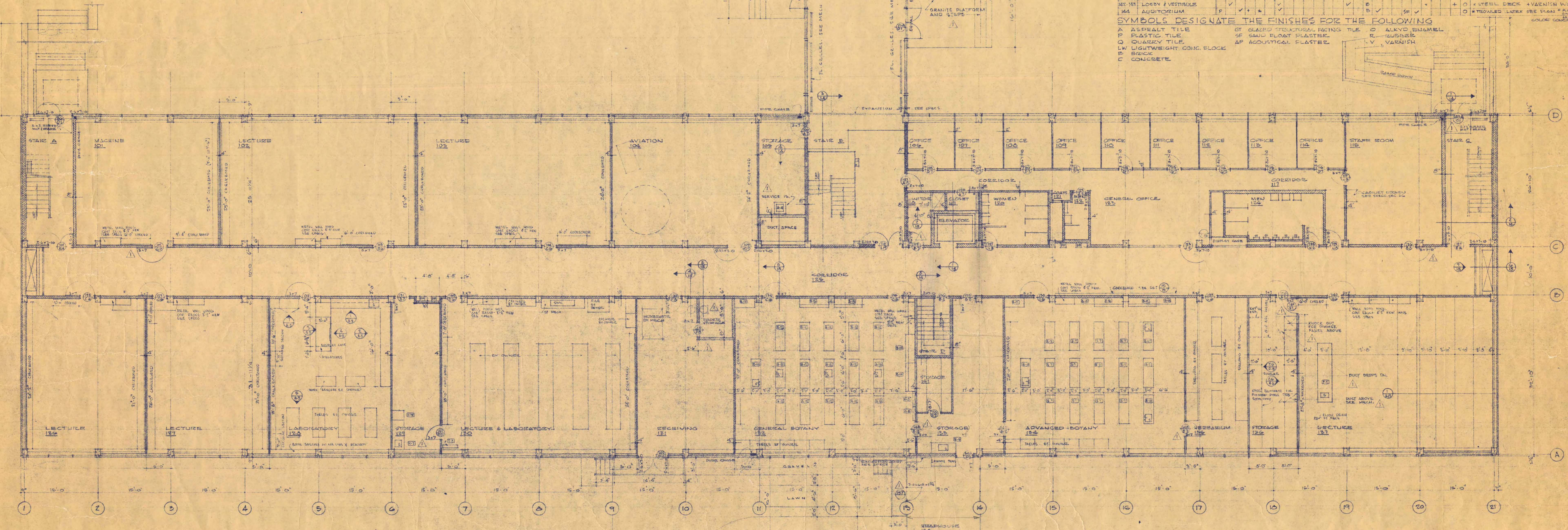

FIRST FLOOR PLAN SCALE 1/8" = 1'-0"

**SCIENCE AND MATHEMATICS BUILDING**  
 ST. CLOUD STATE COLLEGE  
 ST. CLOUD, MINNESOTA

DEPARTMENT OF ADMINISTRATION  
 ROOM 120 STATE CAPITOL BUILDING  
 ARCHITECTURAL AND ENGINEERING DIVISION

STATE OF MINNESOTA  
 ST. PAUL, MINNESOTA

A.J. NELSON, STATE ARCHITECT

TRAYNOR AND HERMANSOHN, ARCHITECTS  
 BAURMAN AND WOOD, INC. CONSULTING ENGINEERS  
 JOHNSON BAKMAN CO. STRUCTURAL ENGINEERS

ST. CLOUD, MINN.  
 ST. PAUL, MINN.  
 MINNEAPOLIS, MINN.

DATE: \_\_\_\_\_ SHEET NO. \_\_\_\_\_

APPROVED BY: \_\_\_\_\_  
 PRESIDENT ST. CLOUD STATE COLLEGE

APPROVED BY: \_\_\_\_\_  
 STATE COLLEGE BOARDS

APPROVED BY: \_\_\_\_\_  
 COMMISSIONER OF ADMINISTRATION  
 AN AUTHORIZED SIGNATURE

APPROVED BY: \_\_\_\_\_  
 STATE PROJECT NUMBER



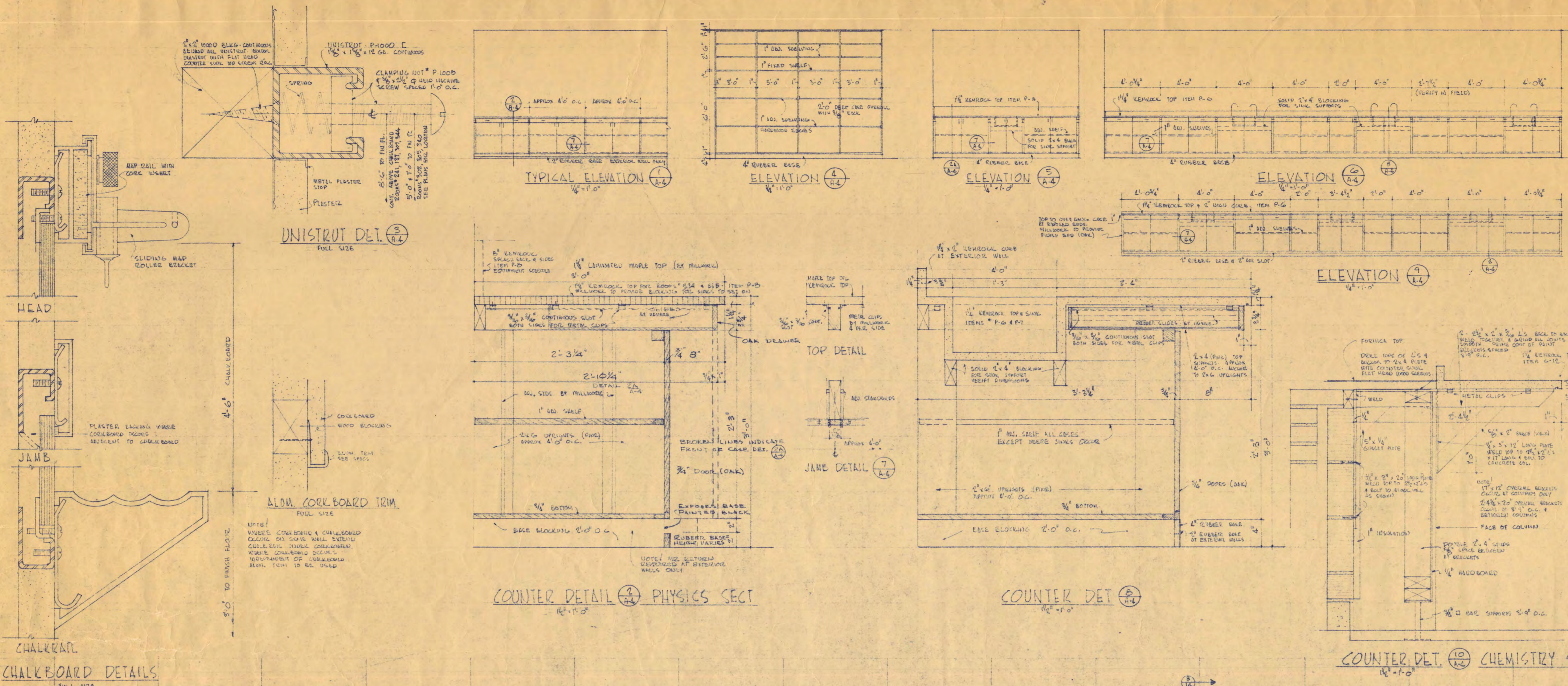

NO.	SPACE	FLOORS					BASE		WALLS		CEILING		PAINT	REMARKS
		1ST	2ND	3RD	4TH	5TH	CONCRETE	OTHER	CONCRETE	OTHER	CONCRETE	OTHER		
201	MAPS & CHARTS													
202	LECTURE													
203	LECTURE													
204	BOTANICAL & BIO. SPEC.													
205	ANIMALS													
206	RESEARCH													
207	RESEARCH													
208	OFFICE													
209	OFFICE													
210	OFFICE													
211	OFFICE													
212	OFFICE													
213	OFFICE													
214	OFFICE													
215	OFFICE													
216	OFFICE													
217	OFFICE													
218	RESEARCH													
219	RESEARCH													
220	RESEARCH													
221	RESEARCH													
222	RESEARCH													
223	RESEARCH													
224	JANITOR													
225	WOMEN'S TOILET													
226	COATS													
227	MEN'S TOILET													
228	GENERAL OFFICE													WALNUT WOOD WALL
229	MEN'S TOILET													
230	LIBRARY													
231	CORRIDOR													
232	LECTURE													
233	GENERAL BIOLOGY													
234	STORAGE													
235	GENERAL BIOLOGY													
236	GENERAL BIOLOGY													
237	STORAGE													
238	GENERAL ZOOLOGY													
239	STORAGE													
240	ADVANCED ZOOLOGY													
241	LECTURE													
242	STAIR A													
243	STAIR B													
244	STAIR C													

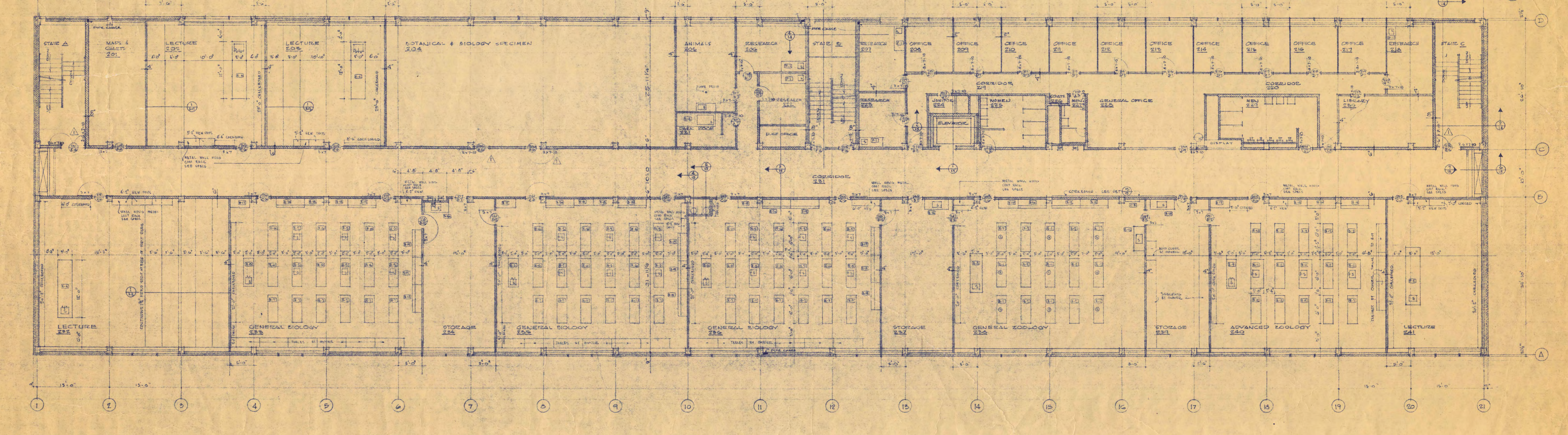
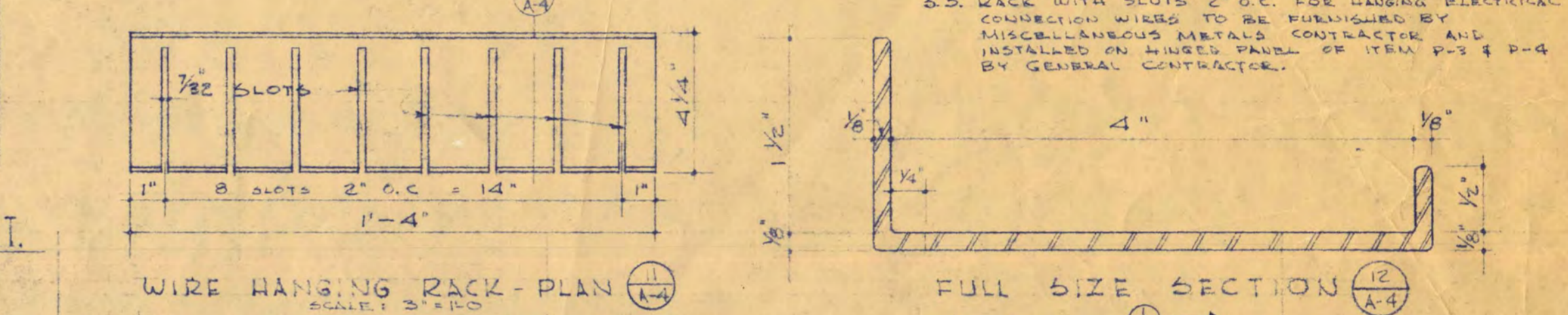

SECOND FLOOR PLAN scale 1/8" = 1'-0"

SCIENCE AND MATHEMATICS BUILDING  
ST. CLOUD STATE COLLEGE  
ST. CLOUD, MINNESOTA

DEPARTMENT OF ADMINISTRATION STATE OF MINNESOTA  
ARCHITECTURAL AND ENGINEERING DIVISION

A. J. NELSON, STATE ARCHITECT

TRAYLOR AND BERGMANSON, ARCHITECTS  
ST. CLOUD, MINN.  
BAUMANN AND MOORE, INC. CONSULTING ENGINEERS  
MINNEAPOLIS, MINN.

DATE: 7-18-59

APPROVED BY: PRESIDENT ST. CLOUD STATE COLLEGE  
APPROVED BY: STATE COLLEGE BOARD  
APPROVED BY: COMMISSIONER OF ADMINISTRATION  
AN AUTHORIZED REPRESENTATIVE

SHEET NO. A-4  
OF 15  
STATE PROJECT NUMBER 8000



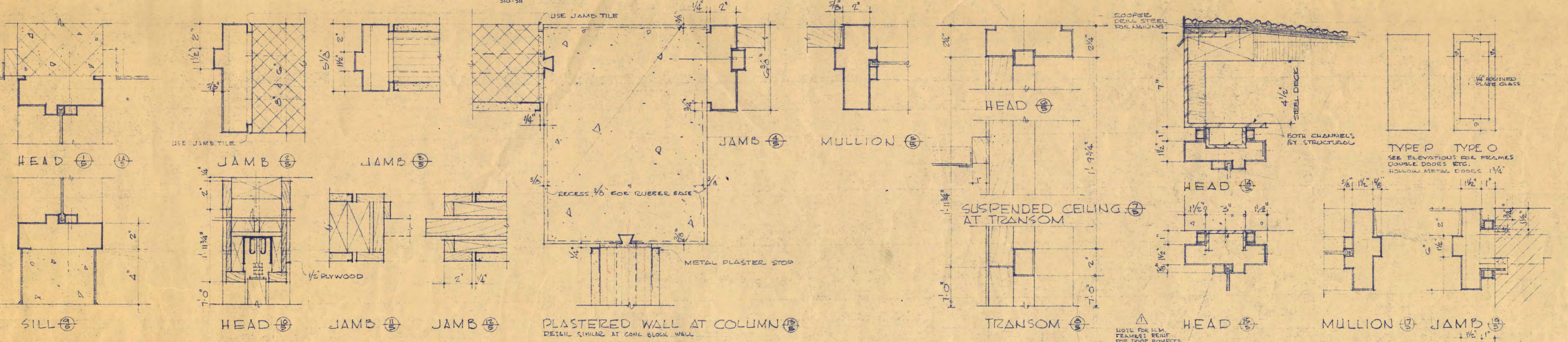
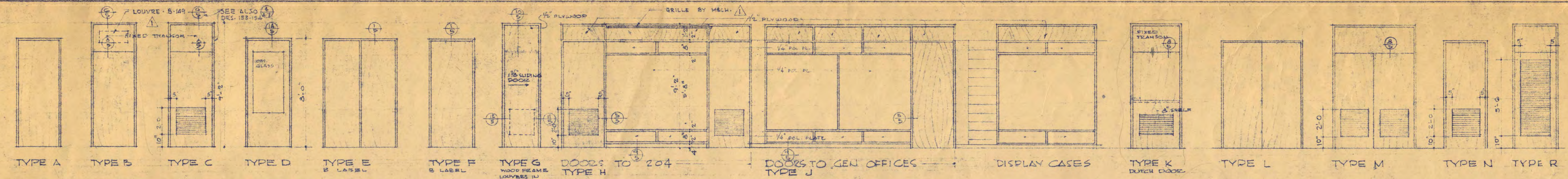

**INTERIOR DOOR DETAILS** scale 3/4"=1'-0"

UNDER CUT THESE DOORS 1/2"

LOUVER NOTES:  
 ALL TYPE C, K, L, N DOORS ARE TO HAVE WOOD LOUVERS EXCEPT THE FOLLOWING, WHICH ARE TO HAVE METAL LOUVERS. SEE SPEC'S: 304, 305, 315, 318, 327, 334, 337, 340.

LINETS:  
 LINETS OVER BATHROOM DOORS ARE PRECAST CONCRETE 2" x 1/2" x 1/2" OVER 10" x 10" x 1/2" IN ALL 304, 305, 340. ALL OTHER DOORS REQUIRING LINETS ARE TO HAVE REINFORCED TILE LINETS.

304 DOOR NUMBER  
 C7 DOOR HARDWARE GROUP  
 DOOR TYPE

**DOOR # HARDWARE IDENTIFICATION**

ALL INTERIOR DOORS ARE 1 3/4" WOOD EXCEPT TYPE O WHICH ARE 1 3/8"

EXTERIOR DOOR DETAILS scale 3/4"=1'-0"

ALL EXTERIOR DOORS ARE 1 3/4" HOLLOW METAL

NOTE: FOR ALL RESEARCH DOOR HARDWARE SEE SPEC'S 149, 150, 151, 152, 153.

ANGLE BY METALS CONTRACTOR

ROOM FINISH SCHEDULE											
NO	SPACE	FLOORS		BASE		WALLS		CEILING		PAINT	
		TERRAZZO	CONCRETE	CERAMIC	WOOD	GLASS	CONCRETE	PLASTER	PLASTER	PLASTER	PLASTER
301	STORAGE										
302	GENERAL PHYSICS										
303	STORAGE										
304	STORAGE										
305	GENERAL PHYSICS										
306	STORAGE										
307	STORAGE										
308	STORAGE										
309	LECTURE										
310	RESEARCH										
311	OFFICE										
312	OFFICE										
313	OFFICE										
314	OFFICE										
315	OFFICE										
316	OFFICE										
317	OFFICE										
318	OFFICE										
319	OFFICE										
320	OFFICE										
321	RESEARCH										
322	CORRIDOR										
323	GENERAL OFFICE										
324	RESEARCH										
325	JANITOR										
326	WOMEN'S TOILET										
327	COATS										
328	MEN'S TOILET										
329	GENERAL OFFICE										
330	MEN'S TOILET										
331	RESEARCH										
332	RESEARCH										
333	CORRIDOR										
334	CLASS ROOM										
335	CLASS ROOM										
336	VACUUM ROOM										
337	BATTERY ROOM										
338	BALANCE ROOM										
339	CREATING										
340	ADVANCED PHYSICS LAB.										
341	STORAGE										
342	SHOP										
343	STORAGE										
344	LECTURE										
345	PHYSICAL & QUANT ANALYSIS										
346	STORAGE										
347	ORGANIC CHEMISTRY										
348	GENERAL CHEMISTRY										
349	STORAGE										
350	STAIRS										
351	STAIRS										

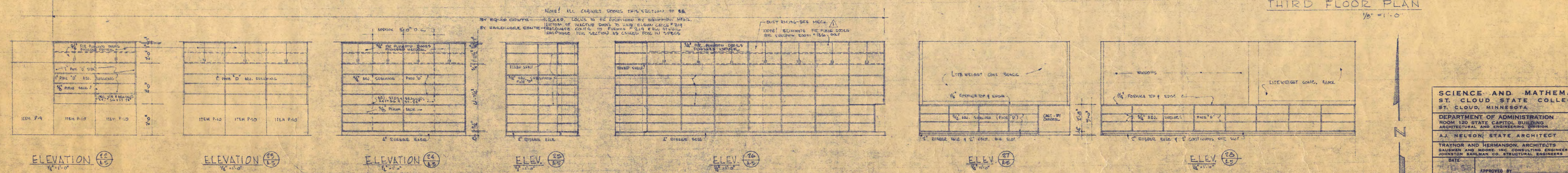
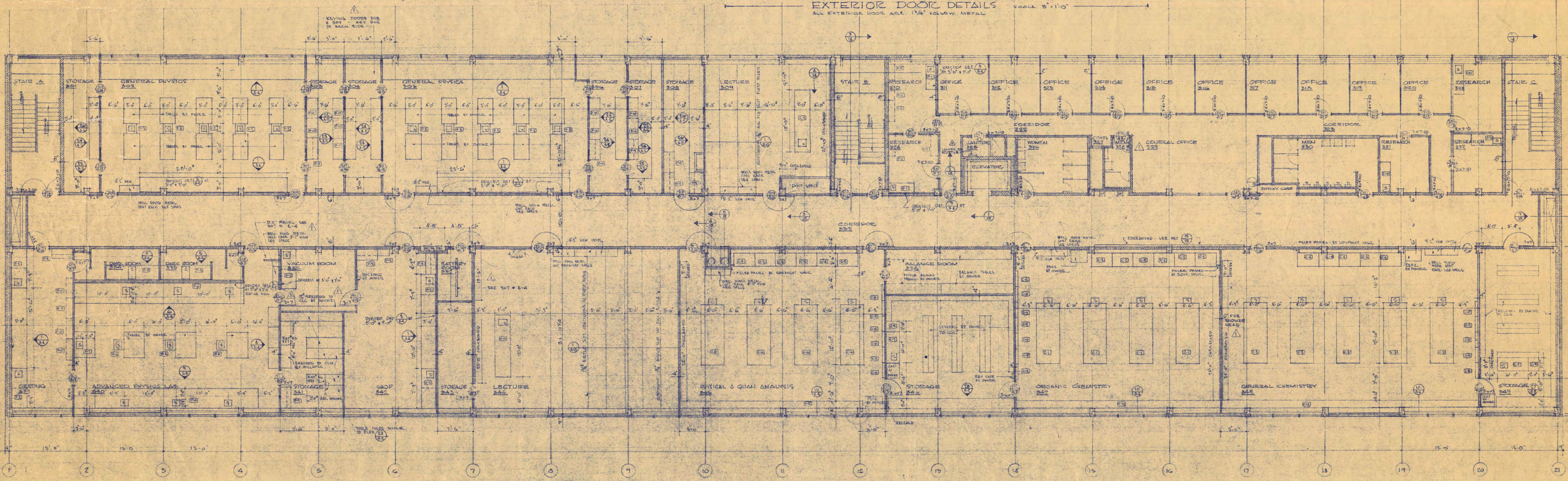

**SCIENCE AND MATHEMATICS BUILDING**  
 ST. CLOUD, MINNESOTA

DEPARTMENT OF ADMINISTRATION STATE OF MINNESOTA  
 ROOM 120 STATE CAPITOL BUILDING ST. PAUL, MINNESOTA

A.J. NELSON, STATE ARCHITECT

TRAYNOR AND HERRMANN, ARCHITECTS  
 BAKERS AND MORE, INC. CONSULTING ENGINEERS  
 JOHNSTON SAHLMAN CO. STRUCTURAL ENGINEERS

ST. CLOUD, MINN.  
 ST. PAUL, MINN.  
 MINNEAPOLIS, MINN.

BHEET NO. 4-5

DATE: 11-13-50  
 REVISED: 11-13-50  
 DRAWN BY: [Name]  
 CHECKED BY: [Name]

APPROVED BY: PRESIDENT OF CLOUD STATE COLLEGE  
 APPROVED BY: STATE COLLEGE BOARD  
 APPROVED BY: COMMISSIONER OF ADMINISTRATION